



CLEAN WATER STATE REVOLVING LOAN FUND PROGRAM

CATEGORICAL EXCLUSION

TO: All Interested Citizens, Government Agencies and Public Groups

In accordance with the Nebraska Clean Water State Revolving Fund environmental review process, which is based on the National Environmental Policy Act, an environmental review has been performed on the proposed agency action below:

This information reviews the environmental impact likely from a project. This project is planned to be federally funded wholly or in part through your tax dollars; therefore, you are entitled to take part in its review. If you have concerns about the environmental impact of this project, please provide them at this time. The Nebraska Department of Environmental Quality (NDEQ) encourages public input in this decision-making process.

PROJECT NAME: Juniata Wastewater Lagoon Rehabilitation and Sludge Removal
APPLICANT: Juniata, Nebraska
COUNTY: Adams County
POPULATION: 755 (2010 Census)
CWSRF PROJECT NUMBER: C318011
NDEQ ID No.: 57744
AWIN SUSTAINABILITY SCORE: 7 (low risk)
TOTAL PROJECT AMOUNT: \$455,000
ESTIMATED CWSRF LOAN AMOUNT: \$455,000

The Village of Juniata is located in Adams County in east central Nebraska. The 2010 census population was 755. A NDEQ Notice of Violation (NOV) was issued on January 3, 2018 for lagoon dike damage from erosion. The Village hired a Consulting Engineer who submitted plans and specifications to the Department for repair of the eroded dikes on December 22, 2018. The Department issued a State Construction Permit No. 2018-0254 on January 2, 2019 approving the plans and specifications. The project will repair the interior dike slopes of lagoon cells 2 and 3 and add riprap to the interior slopes to protect from future erosion. Sludge will be removed from all three lagoon cells and land applied in accordance with NDEQ Title 119, Chapter 12. Improvements to the irrigation pump and landing in cell 3 will be done. Repairs will be made to the diversion and inlet structure and interconnecting structure. The project opened bids January 7, 2019 and awarded the project to Van Kirk Brothers Construction. A change order will be processed adding the SRF federal assurances to the contract documents.

The project is eligible for financing through the Clean Water State Revolving Loan Fund (CWSRF) and is listed on the planning list of the SFY2019 Intended Use Plan (IUP). Juniata qualifies for a 20-year loan at a current program interest rate of 1.5 percent. In addition to principal and interest payments, an administrative fee of 1.0 percent of the outstanding principal balance will be assessed each year.

Sewer use fees would be pledged to repay the loan. Current residential sewer use rates are a flat rate of \$34.08 per month. The Village of Juniata is estimated to have approximately 341 residential and commercial sewer connections. Sewer rates were raised in 2018 by \$10.00 per month to cover the proposed SRF debt service and 10 percent coverage requirement. The sewer rate will be evaluated at the completion of the project to ensure coverage of final debt service and O&M costs.

The project will result in continued wastewater collection and treatment of sewage flows from the Village. The project will increase storage capacity for their complete retention wastewater treatment lagoons by removal of an estimated 18 inches of sludge in the lagoons. Land application of sludge will comply with NDEQ Title 119 Chapter 12, Land Application of Domestic Effluent and Biosolids. The project will have a positive impact on the environment preventing any breach of the lagoon dikes. Treated lagoon effluent shall be land applied at an agronomic rate and monitored for the following parameters: pH, Total Kjeldahl Nitrogen, Nitrate and Nitrogen, Ammonia as Nitrogen, Total Dissolved Solids, Chloride, Phosphorous, and Sodium Adsorption Ratio.

The review did not indicate a significant environmental impact would result from the proposed action. The project is located next to but outside the 100 year flood plain of Thirty-Two Mile Creek. The project will monitor for nesting and migratory birds, which could be disturbed by construction. The construction contract documents will require the contractor to satisfy the requirements of the Federal Migratory Bird Treaty Act. The project does not discriminate against any segment of the community's population nor suffers disproportionately from human health or environmental effects.

The project was reviewed for eligibility for a categorical exclusion from National Environmental Policy Act review specified in 40 CFR (Code of Federal Regulations) Part 6.204. The project meets all criteria described in the above reference and the Department has determined that this project is eligible for categorical exclusion. Consequently, a preliminary decision has been made that a Finding of No Significant Impact will not be prepared. The project as proposed is solely replacement of existing facilities.

Justification for categorical exclusion includes:

- The proposed action is not known or expected to have potentially significant environmental impacts on the quality of the human environment either individually or cumulatively over time;
- The proposed action is not known or expected to significantly affect federally listed threatened or endangered species or their critical habitat;
- The proposed action is not known or expected to significantly affect national natural landmarks or any property with nationally significant historic, architectural, prehistoric archeological or cultural value, including but not limited to, property listed on or eligible for the National Register of Historic Places;
- The proposed action is not known or expected to significantly affect environmentally important natural resource areas as wetlands, prime farmland, floodplains, wild and scenic rivers, and significant fish or wildlife habitat. The existing wastewater lagoons are outside the 100 year floodplain.
- The proposed action is not known or expected to have a significant effect on the pattern and type of land use (industrial, commercial, agricultural, recreational, residential) or growth and distribution of population including altering the character of existing residential areas, or may not

be consistent with state or local government, or federally-recognized Indian tribe approved land use plans or federal land management plans.

- The proposed action is not known or expected to cause significant public controversy about a potential environmental impact of the proposed action.

The Nebraska Department of Environmental Quality shall revoke the categorical exclusion and shall require a full environmental review if, subsequent to the granting of exclusion, the state determines that the proposed project no longer meets the requirements for a categorical exclusion due to changes in the proposed project; or new evidence reveals that serious local or environmental issues exist; or federal, state, local or tribal laws are being violated.

This action is taken on the basis of careful review of the application and other supporting data, which are on file in the office of the NDEQ. These are available for public review upon request. Persons having a comment on this categorical exclusion determination are encouraged to submit such comments directly to Tom Fuenning, Review Engineer, of the Technical Assistance Section of NDEQ, who can be reached at (402) 471-4989 or email: tom.fuenning@nebraska.gov.

Signed this 8th day of February, 2019.

Sincerely,



Jim Macy
Director

JM/tsf

Attachments:

Distribution List
Maps

CATEGORICAL EXCLUSION DISTRIBUTION LIST
JUNIATA, NEBRASKA

DEPARTMENT OF ENVIRONMENTAL QUALITY
Office of Public Affairs
P.O. Box 98922
Lincoln, NE 68509-8922

DEPARTMENT OF HEALTH AND HUMAN
SERVICES - REGULATION AND LICENSURE
Steve McNulty
P.O. Box 95026
Lincoln, NE 68509-5026

DEPARTMENT OF NATURAL RESOURCES
Mitch Paine
P.O. Box 94676
Lincoln, NE 68509-4676

NEBRASKA GAME & PARKS COMMISSION
Craig Wacker/Carey Grell
P.O. Box 30370
Lincoln, NE 68503-0370

DIRECTOR, NEBRASKA STATE
HISTORICAL SOCIETY
P.O. Box 82554
Lincoln, NE 68508-2554

STATE OFFICE OF POLICY RESEARCH
Policy Advisor
Rm 1319, State Capitol
P.O. Box 94601
Lincoln, NE 68509-4601

DEPARTMENT OF ECONOMIC DEVELOPMENT
Steve Charleston
P.O. Box 94666
Lincoln, NE 68509

DEPARTMENT OF THE INTERIOR
FISH AND WILDLIFE SERVICE
Eliza Hines
9325 South Alda Road
Wood River, NE 68883

NATIONAL PARK SERVICE
Nick Chevance
Environmental Coordinator
Midwest Regional Office
601 Riverfront Drive
Omaha, NE 68102-4226

USDA RURAL DEVELOPMENT
Ken Shaw
Room 308, Federal Building
100 Centennial Mall North
Lincoln, NE 68508

ENVIRONMENTAL PROTECTION AGENCY
Chris Simmons/Kelly Beard-Tittone
11201 Renner Blvd
Mail Code: WWPDWIMB
Lenexa, KS 66219

STATE CONSERVATIONIST
Natural Resources Conservation Service
Federal Building, Room 345
100 Centennial Mall North
Lincoln, NE 68508

DEPARTMENT OF THE ARMY
John Moeschel
State Program Manager
US Army Corps of Engineers
Nebraska State Office, Suite 1
8901 South 154th Street
Omaha, NE 68138-3621

APPLICANT:
Mark Renschler, Chairman
Village of Juniata
911 N. Juniata Ave.
Juniata, NE 68955

CONSULTING ENGINEER:
Steve Wolford, P.E.
W Design
2626 West 2nd Street
Hastings, NE 68901

LOCAL NEWSPAPER:
Hastings Tribune
908 West Second
Hastings, NE 68901
(Public Information Only not for Public Notice)

NATURAL RESOURCES DISTRICT:
Little Blue NRD
PO Box 100
110 West 2nd
Davenport, NE 68335-0100

VILLAGE OF JUNIATA

WASTEWATER TREATMENT FACILITY REPAIRS

JUNIATA, NE

RECEIVED
DEC 26 2015
Nebraska Dept of Environmental Quality
By: [Signature]

SHEET INDEX	
SHEET #	SHEET TITLE
CVR	COVER PAGE
C-1	SITE PLAN AND SECTIONS
C-2	INLET STRUCTURE DETAILS
C-3	DIVERSION STRUCTURE DETAILS

TABLE OF QUANTITIES			
ITEM	DESCRIPTION	ESTIMATED	
		QUANTITY	UNIT
1	MOBILIZATION	1	L.S.
2	DEWATERING, INCL. 1, 2 & 3	1,512	1000 GAL.
3	SLUDGE REMOVAL AND DISPOSAL	18,302	C.Y.
4	GRADING	6,713	C.Y.
5	BENTONITE SEAL	1	LB.
6	CONSTRUCT ACCESS AREA, BLOCK	45	EA.
7	RIPRAP WITH 10% S.F.	2,330	TONS
8	SEEDING	3.91	ACRE
9	DIVERSION BOX #1 REPAIR, D-2	1	L.S.
10	DIVERSION BOX #2 REPAIR, D-3	1	L.S.
11	REPAIR OVERFLOW STRUCTURES, D-4, 5 & 6	3	EA.
12	INLET STRUCTURE REPAIR, D-1	1	L.S.
13	TESTING ALLOWANCE	1	L.S.

LINE TYPE LEGEND

- EXISTING PROPERTY LINE
- EXISTING 8" WATER LINE
- EXISTING 6" WATER LINE
- NEW 8" WATER
- EXISTING OVERHEAD ELECTRIC
- EXISTING GAS LINE, " SIZE
- EXISTING FIBER OPTIC
- EXISTING UNDERGROUND CABLE
- EXISTING UNDERGROUND TELEPHONE
- EXISTING SEWER
- EXISTING FENCE
- 1960 --- EXISTING CONTOURS



LOCATION MAP
NO SCALE

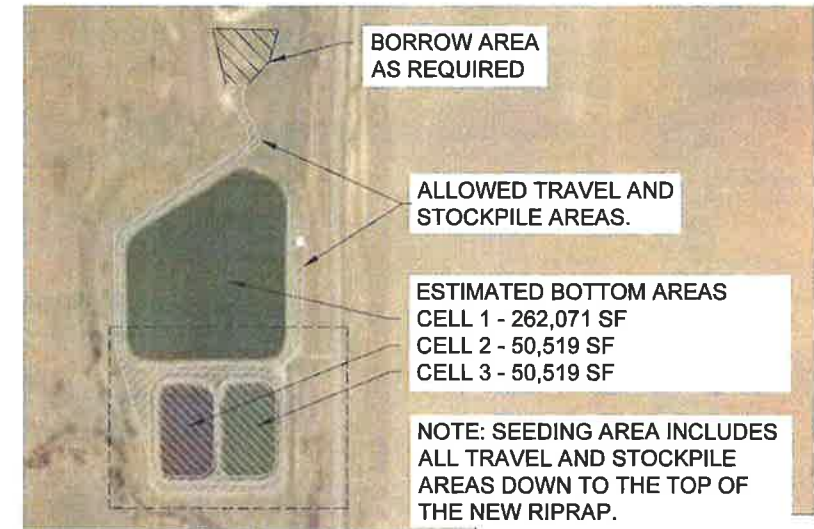

SITE PLAN
SCALE: 1" = 300'

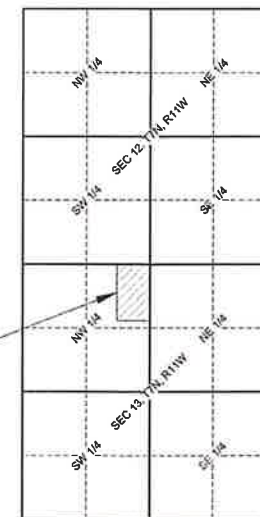

VICINITY MAP
NO SCALE

JUNIATA RIPRAP RENOVATION
WASTEWATER TREATMENT FACILITY REPAIRS
 JUNIATA, NE

WDA W DESIGN ASSOCIATES
 Consulting Engineers and Architects
 McCook, Nebraska 68001
 Hastings, Nebraska 68901



DWG:	917K-18 Cover
DRAWN:	SWW
CHECKED:	
REVISIONS:	

CVR

DATE: DEC, 2015

JUNIATA WASTEWATER TREATMENT FACILITY RIPRAP RENOVATION PROJECT - COVER SHEET - 12/23/2015 10:48 AM - DWG: 917K-18 Cover

I, [Name], hereby certify that the
 information furnished on this
 drawing is true and correct to the
 best of my knowledge and belief,
 and that I am a duly licensed
 professional engineer in the State
 of Nebraska.
 W. D. WOODFORD
 No. 0299
 State of Nebraska

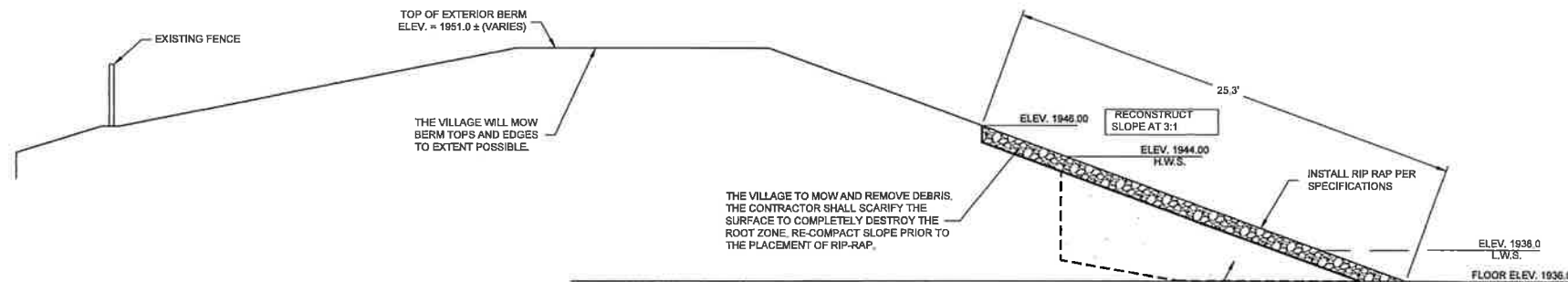

CONCRETE NOTES

- ALL CONCRETE SHALL BE CLASS "47B" CONCRETE, REINFORCED AS SHOWN.
- ALL SUBGRADE UNDER CONCRETE SHALL BE COMPACTED TO 95% OF STANDARD PROCTOR DENSITY AT 2% FROM OPTIMUM MOISTURE.
- MINIMUM COVER OVER REINFORCEMENT SHALL BE 3" AGAINST EARTH AND 2" WHERE EXPOSED TO AIR.
- MINIMUM LAP SPLICE SHALL BE AS FOLLOWS:
#4 BARS = 18"
#5 BARS = 24"
#6 BARS = 30"
- REBAR SHALL BE SET ON CONCRETE BLOCKS OR CHAIRS. DO NOT SET ANY REBAR IN CONTACT WITH THE GROUND.

BENCHMARK DATA

- LOCATED ON THE NORTHEAST CORNER OF CONCRETE WITH A CHISELED "X". ELEV. = 1956.13
- LOCATED ON THE SOUTHWEST CORNER OF OUTLET STRUCTURE CONCRETE WITH A CHISELED "X". ELEV. = 1954.29
- LOCATED ON THE CONCRETE SURROUNDING THE WATER VALVE WITH A CHISELED "X". ELEV. = 1953.72
- LOCATED ON THE NORTH RIM OF MANHOLE WITH AN "X". ELEV. = 1955.03

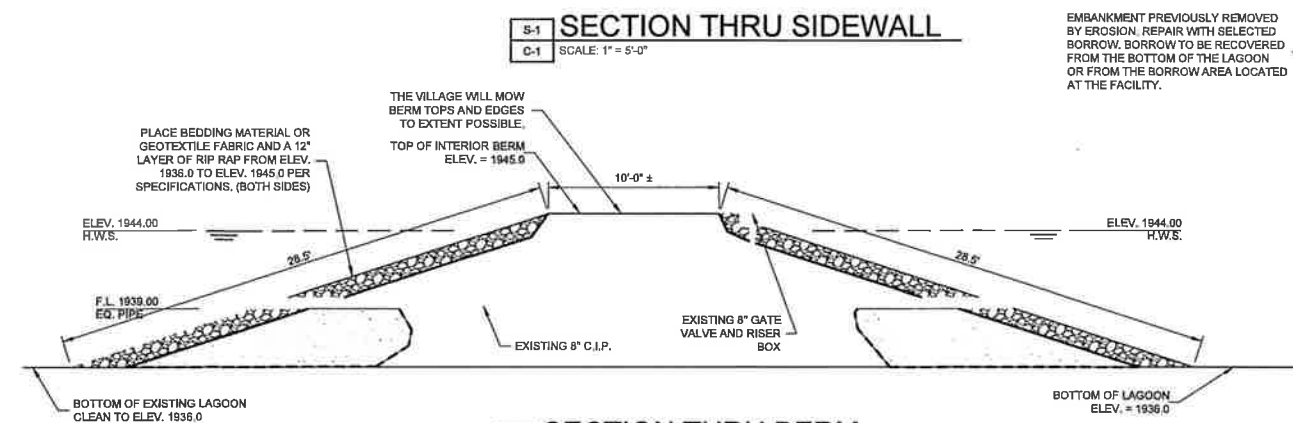

FOOTING SCHEDULE

FOOTING	SIZE	REINFORCING	CAGE
'A'	3'-0" DIA. x 8'-0"	SEE DETAIL	9 - #6 VERT. BARS w/ #4 TIES @ 12" C/C

- SYMBOL LEGEND**
- EXISTING POWER POLE
 - ▲ EXISTING TELEPHONE RISER
 - EXISTING GAS METER
 - ⊙ EXISTING ROAD SIGN
 - ⊙ EXISTING SEWER MANHOLE
 - ⊙ EXISTING SECTION MARKER
 - ⊙ EXISTING FIRE HYDRANT
 - ⊙ WATER VALVE

- LINE TYPE LEGEND**
- EXISTING PROPERTY LINE
 - EXISTING 8" WATER LINE
 - EXISTING 6" WATER LINE
 - EXISTING GAS LINE
 - EXISTING 8" SEWER
 - EXISTING FENCE
 - EXISTING CONTOURS

LAGOON REHABILITATION NOTES:

- THE VILLAGE OPERATOR SHALL PUMP LAGOONS 1, 2 AND 3 TO THE LOWEST LEVEL POSSIBLE. LAGOONS 2 AND 3 WILL BE AT APPROXIMATELY 2 FEET WHICH WILL LEAVE APPROXIMATELY 650,000 GALLON IN EACH.
- THE CONTRACTOR SHALL PUMP THE BALANCE OF THE WATER FROM LAGOONS 2 AND 3 TO LAGOON 1. IF ALL THE WATER CANNOT BE STORED IN LAGOONS 1, THEN THE VILLAGE WILL PROVIDE FOR DISCHARGING FROM LAGOON 2-3 AS PER N.D.E.Q. INSTRUCTIONS.
- THE LAGOONS 2 AND 3 SHALL BE ALLOWED TO DRY TO FACILITATE OPERATING EQUIPMENT FOR SLUDGE REMOVAL AND REPAIR OF SLOPES.
- ONCE SLOPES HAVE BEEN REPAIRED AND RIP RAP PLACED, THE VILLAGE SHALL OPERATE THE DROP PIPE SYSTEM TO REPLACE THE WASTEWATER FROM LAGOON 1 TO LAGOONS 2 AND 3 TO A DEPTH OF 2.0 FEET.
- THE VILLAGE WILL SUPPLY ADDITIONAL WATER IF REQUIRED.

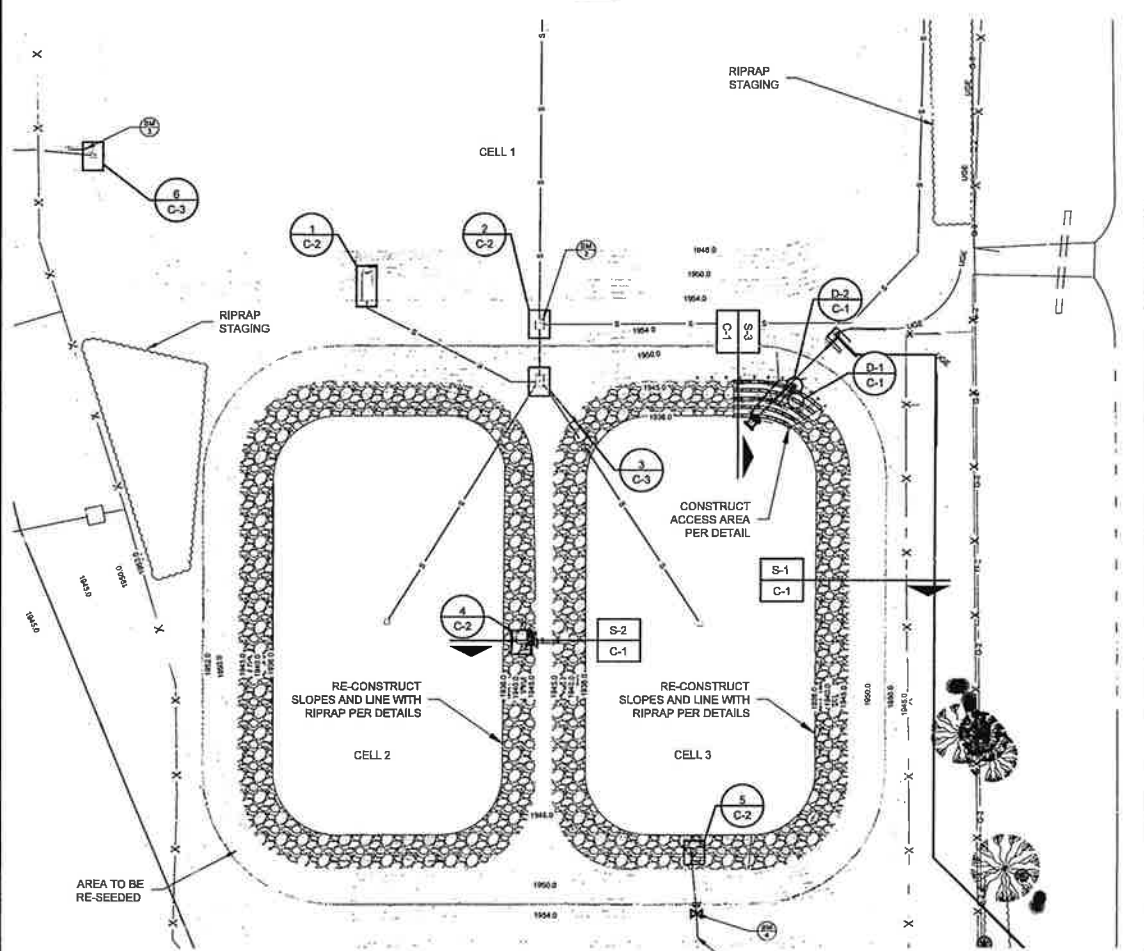

1 SITE PLAN
SCALE: 1" = 60'-0"

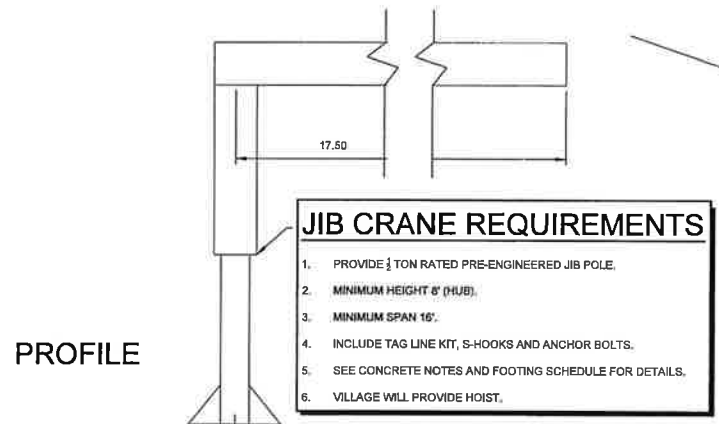

JIB CRANE REQUIREMENTS

- PROVIDE 1/2 TON RATED PRE-ENGINEERED JIB POLE.
- MINIMUM HEIGHT 8' (HUB).
- MINIMUM SPAN 16'.
- INCLUDE TAG LINE KIT, S-HOOKS AND ANCHOR BOLTS.
- SEE CONCRETE NOTES AND FOOTING SCHEDULE FOR DETAILS.
- VILLAGE WILL PROVIDE HOIST.

D-2 JIB POLE AND FOOTING DETAIL
SCALE: 1/2" = 1'-0"

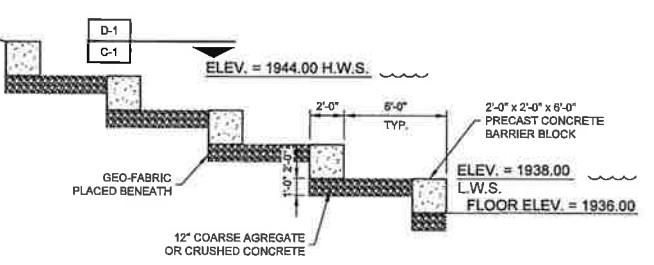

S-3 SECTION THRU ACCESS AREA
SCALE: 1" = 5'-0"

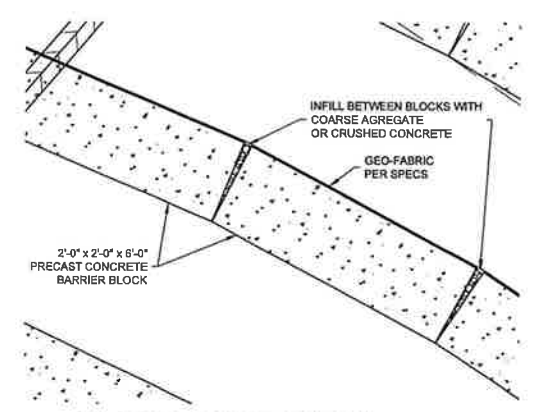

D-1 BLOCK JOINT DETAIL
SCALE: 1/2" = 1'-0"

I, Steve W. Volz, am the
Contributing Professional on the
Waste Treatment Improvement
Project.
This bar is one inch long on original drawing.
If not one inch on this sheet, adjust scales accordingly.

SCOPYRIGHT
This document and the information contained hereon are
reproduced or incorporated herein without the express written
permission of W Design Associates. Unauthorized
copying or disclosure of construction information is prohibited by
the copyright law.

**JUNIATA RIPRAP RENOVATION
WASTEWATER TREATMENT FACILITY REPAIRS**
JUNIATA, NE

WDA W DESIGN ASSOCIATES
Consulting Engineers and Architects
McCook, Nebraska 68001
Hastings, Nebraska 68901



DWG: 917R-18 C-1
DRAWN: M. SWART
CHECKED: REVISIONS

C-1

DATE: DEC., 2018